

WARNING

- Do not use any substance other than distilled water. Take care when using essential oils or herbs, so as not to contaminate the water used for steaming.
- NEVER point the vapor jet directly in the face of a customer.
- NEVER use the steamer unit in humid or poorly ventilated environments.
- NEVER use the steamer outdoors.
- NEVER attempt to open the steamer casing/housing by yourself.
- If the power cord was destroyed, please ask a professional to service and replace it to avoid hazards, or contact the dealer for service.
- Do not let the steamer run dry. If it does, the warranty is voided.

EC-DECLARATION OF COMPLIANCE

This product meets the following requirements:

- 1.** Conditions set out in the Low Voltage Directive: 2006/95/EC
- 2.** Conditions set out in the Electromagnetic Compatibility Directive: 2004/108/EC

RECYCLING

 Whenever any of our electrical products or their presentation packaging bear this symbol, it means that these products should not be treated as conventional household waste in Europe. To ensure proper treatment of this waste, dispose of it in accordance with local laws or as required for the disposal of electrical equipment. This initiative will help preserve save natural resources and improve standards of environmental protection in regard to the treatment of electrical waste.

WELCOME!

Thank you very much for purchase. Please read the instructions carefully before operating the instrument. You can also ask a professional for guidance to make sure you are using the instrument correctly. We will accept no responsibility for any accidents that occur due to

incorrect operation.

The company reserves the right to amend the details of the instruments with no prior notice. If any mistakes are found in these instructions, please feel free to send us an e-mail informing us so that we can correct them.

PACKAGE CONTENTS

- These components are subject to change without prior notice.
- Appearance of product may differ from the image.

No.	PRODUCT	REF.	QTY.
1	F-100C	-	1
2	WATER TANK	10051	1
3	SPRAYING NOZZLE	10089	1
4	EXTENSION ARM 1	10090	1
5	EXTENSION ARM 2	10094	1
6	FILLER LID	-	1
7	WOOL FELT	-	5
8	17,5X2 SEAL RING	-	2
9	23X3 SEAL RING	-	2

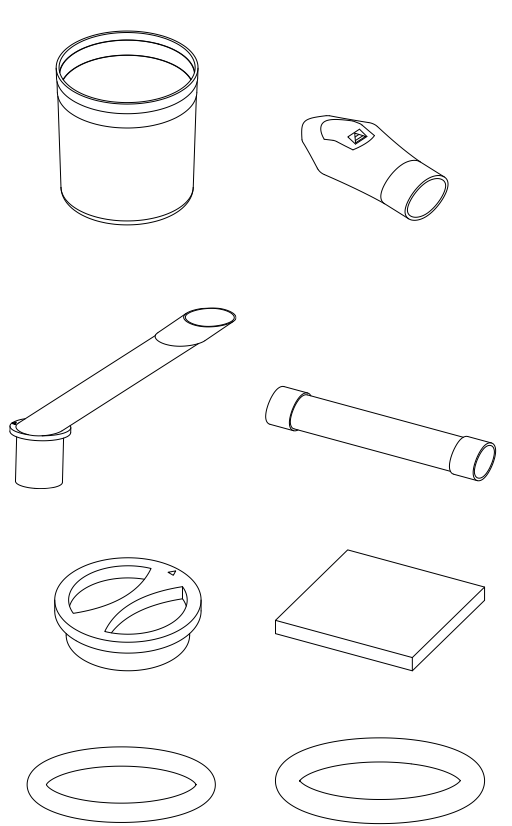
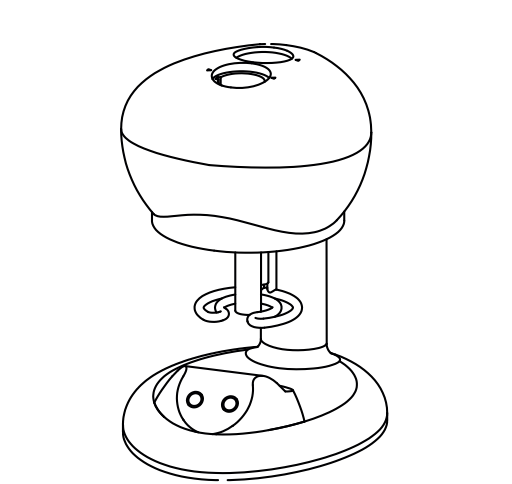

FRONT PANEL

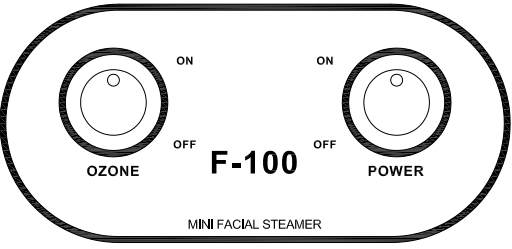

INSTRUCTIONS OF USE

ASSEMBLY

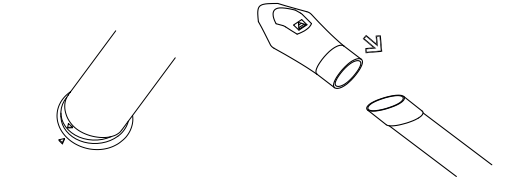

FILLING WITH WATER

1. Remove the lid from the top of the steamer.

2. Fill the cup with water through the hole.

Note: The water level should be between the “MAX” and “MIN” levels marked on the cup.

3. Replace the lid.

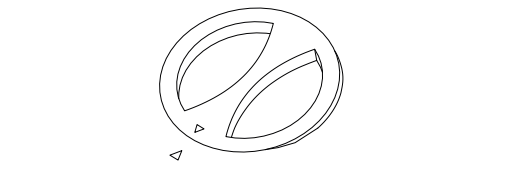

FRAGRANCE TREATMENT

- Pour a little essential oil into the balsam case of the spray head.

- 5 parts of wool felt are delivered for replacement.

STARTING TREATMENT

1. Turn on the “POWER” button:

- The heater begins to work.

- After about 6 min, steam will spray out from the nozzle.

2. As of this moment, you can turn on the “OZONE” button:

- The ozone lamp comes on and starts working.

3. Whenever the water level reaches the lower limit, turn off the “POWER” button. Remove the herb lid once steam stops coming out, add some distilled water and switch back on to resume operation.

SUGGESTION OF TREATMENT

SKIN TYPES	DIST.	TIME
Greasy skin, poor blood circulation	25 cm	15 min
Normal skin	25cm	10 min
Sensitive skin, dry skin	30cm	5 min
Capillary vessel expansion	30cm	5 min

CAUTIONS

- When operating the machine, do not point the nozzle at the customer's face until the steam is coming out thinly and evenly.
- The steam should first spray the customer's jaw and then the rest of the face.

FAQ

If the unit emits steam mixed with hot water.

1. Clean the water cup with vinegar and rinse with clean water.

2. Fill the water cup with clean water and add 8 to 10 drops of vinegar. Turn on the steamer for the time of one operation (do not use it with a patient!).

3. When the operation time ends, turn off the steamer and rinse the cup with clean water.

4. Use the steamer during the time of 2 whole operations with clean water.

MAINTENANCE

It is advisable to clean your steamer at least once a week and also to decalcify the water heater element. Please follow the steps below:

TECHNICAL SHEET

Adjustments	Upper height limit (cm)	45
	Lower height limit (cm)	35
	Rotation of arm	360°
	Rotation of the nozzle	360°
	Extension fo the arm (cm)	16,5
Weights and sizes	Packing size (cm)	30x26x21
	Gross weight (kg)	13,6
Water tank	Material	Methacrylate
	Capacity	0,5 liters
Working characteristics	Preheat time	6 min. (approx.)
Electrical characteristics	Rated voltage	220V ~ 240V
	Frequency	50Hz/60Hz
	Rated power	500 W
Fragances	Yes	
Ozone	Yes	
Deposit for herbs	No	

1. Once the steamer unit is cold, remove the water cup.

2. Fill the cup with the appropriate decalcification/water solution and leave it to stand overnight.

3. Remove the water and rinse with clean water to get rid of any residue from the decalcification agent.

4. Refill with water and run the steamer through at least one run cycle in order to remove any remaining residue from the steamer unit.

5. Remove the cup and rinse as before.

6. Refill with water and it is ready for use.

Note: Failure to remove all the decalcification residue may cause the steamer to ‘spit’. If this occurs, simply repeat the rinse and refill procedure until the issue is resolved.

ACCESSORIES

REF.	DESCRIPTION
10051	WATER TANK
10089	SPRAYING NOZZLE
10090	EXTENSION ARM 1
10094	EXTENSION ARM 2